

WISCONSIN
CHIPPEWA COUNTY

SHEET INDEX	
SHEET	SHEET DESCRIPTION
C1.0	TITLE SHEET
C1.1	EXISTING SITE CONDITIONS
C1.2	REMOVAL PLAN
C1.3	SITE PLAN
C1.4	GRADING & EROSION CONTROL PLAN
C1.5	EROSION CONTROL PLAN
C1.6	DETAILS
C1.7	DETAILS

I HEREBY CERTIFY THAT THIS PLAN WAS PREPARED BY ME OR UNDER MY PERSONAL DIRECTION AND CONTROL AND THAT I AM A DULY REGISTERED PROFESSIONAL UNDER THE LAWS OF THE STATE OF WISCONSIN.

DIGGERS HOTLINE
Dial **811** or (800) 242-8511
www.DiggersHotline.com

LOCATION MAP
WHEATON BOAT LAUNCH

—PROJECT
LOCATION

JOB NO.
3984-O10

BOOK NO.

DRAWN BY
D B

CHECKED BY
XX

DATE
JAN. 2022

REVISIONS

REFERENCE FILE

DRAWING FILE
W3984-10-TL.dwg

Cedar Corporation

*commercial availability, chemistry, environmental products
roof membranes • waterproofing • interior waterproofing*

www.cedarcorp.com
800-472-7372

<p>15497 N. Washington Ave. Suite 200 Minneapolis, MN 55412 Tel: 612-251-3633 Fax: 612-251-3586</p>	<p>1402 Madison Street Suite 200 Dallas, TX 75201 Tel: 972-481-9431 Fax: 972-481-5824</p>	<p>604 Wilson Ave. Suite 100 Hingham, MA 01931 Tel: 508-735-2327 Fax: 508-735-2327</p>
---	---	--

NEW PUBLIC DOCK
TOWN OF WHEATON BOAT LAUNCH
106th STREET
TOWN OF WHEATON, WI

SHEET NO.

C1.0

\\Clients-Memo\W\W18184 Town of Wheaton\010 Recreational Boating Facilities\Draw and Design\100 Conf\Fig\00base_3984010.dwg 05/26/22 5:22:05 PM

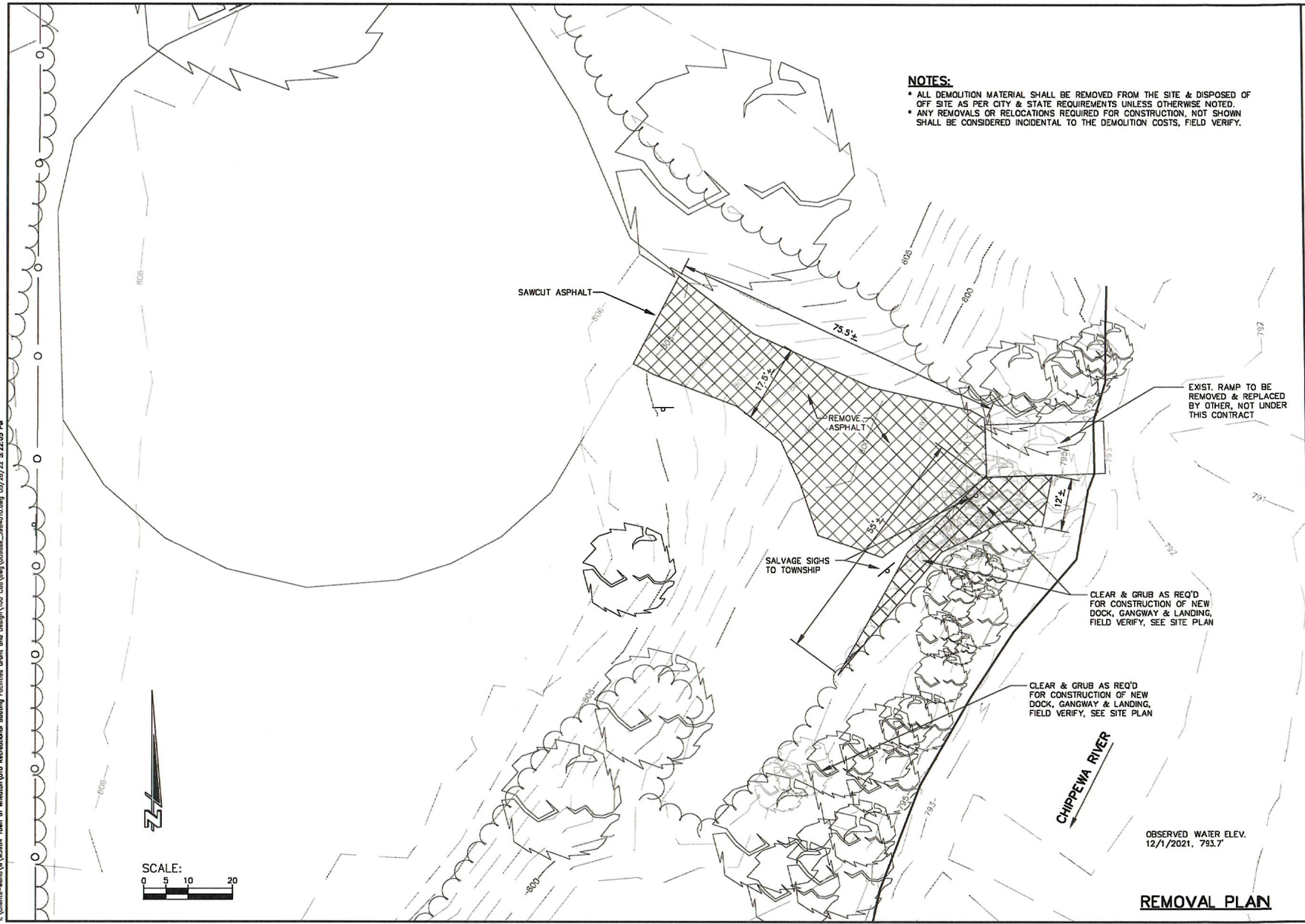

JOB NO.	3984-010
BOOK NO.	
DRAWN BY	D B
CHECKED BY	XX
DATE	JAN. 2022
REVISIONS	
REFERENCE FILE	
DRAWING FILE	00base_3984010.dwg

Cedar Corporation
www.cedarcorp.com
800-472-7372
engineers • architects • planners • environmental scientists
land managers • landscape architects • interior designers

183457 Westlawn Ave. Chippewa Falls, WI 54926
248-2000 FAX 248-2001
183457 Westlawn Ave. Chippewa Falls, WI 54926
248-2000 FAX 248-2001

**NEW PUBLIC DOCK
TOWN OF WHEATON BOAT LAUNCH
106th STREET
TOWN OF WHEATON, WI**

SHEET NO.
C12

I:\Clients-Wino\W3884 Town of Wheaton\010 Recreational Boating Facilities Drent and Design\100 Con\Views\00base_3984010.dwg 05/26/22 5:22:26 PM

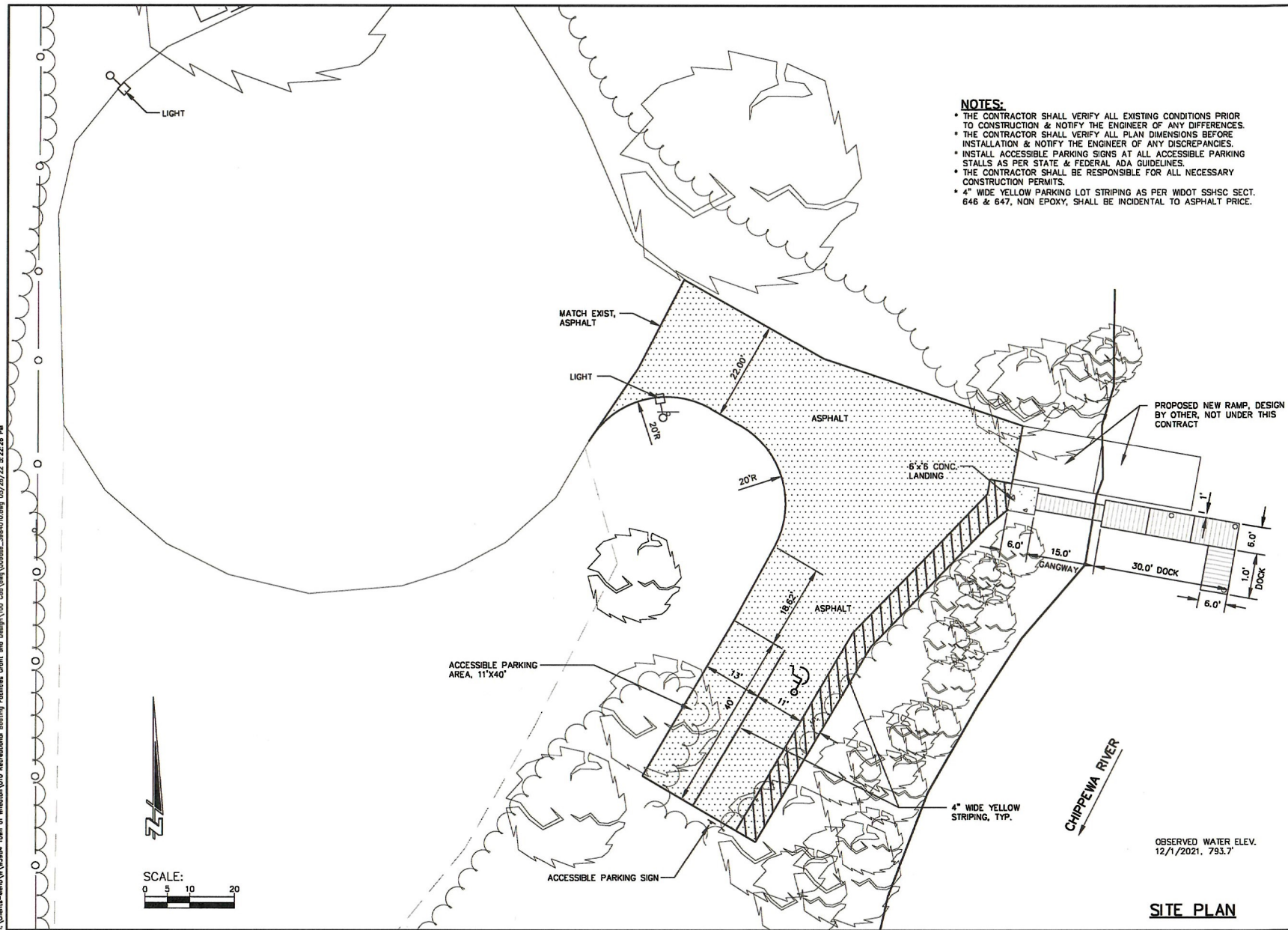

- NOTES:**
- THE CONTRACTOR SHALL VERIFY ALL EXISTING CONDITIONS PRIOR TO CONSTRUCTION & NOTIFY THE ENGINEER OF ANY DIFFERENCES.
 - THE CONTRACTOR SHALL VERIFY ALL PLAN DIMENSIONS BEFORE INSTALLATION & NOTIFY THE ENGINEER OF ANY DISCREPANCIES.
 - INSTALL ACCESSIBLE PARKING SIGNS AT ALL ACCESSIBLE PARKING STALLS AS PER STATE & FEDERAL ADA GUIDELINES.
 - THE CONTRACTOR SHALL BE RESPONSIBLE FOR ALL NECESSARY CONSTRUCTION PERMITS.
 - 4" WIDE YELLOW PARKING LOT STRIPING AS PER WDOT SSHSC SECT. 646 & 647, NON EPOXY, SHALL BE INCIDENTAL TO ASPHALT PRICE.

OBSERVED WATER ELEV.
12/1/2021, 793.7'

SITE PLAN

JOB NO.
3984-010
BOOK NO.
DRAWN BY
D B
CHECKED BY
XX
DATE
JAN. 2022
REVISIONS
REFERENCE FILE
DRAWING FILE
00base_3984010.dwg

www.cedarcorp.com
900-472-7372

Cedar Corporation
engineers, architects, planners, environmental scientists
and managers • sustainable architecture • interior design

1035 Belmont Street
Suite 200
Wheaton, IL 60187
TEL: 815-398-3000
FAX: 815-398-3004

1035 Belmont Street
Suite 200
Wheaton, IL 60187
TEL: 815-398-3000
FAX: 815-398-3004

**NEW PUBLIC DOCK
TOWN OF WHEATON BOAT LAUNCH
106th STREET
TOWN OF WHEATON, WI**

SHEET 12

C12

I:\Clients\New\W\W3984 Town of Wheaton\010 Recreational Boating Facilities\Grnt and Design\100 Civil\Draw\00base_3984010.dwg 05/28/22 5:22:44 PM

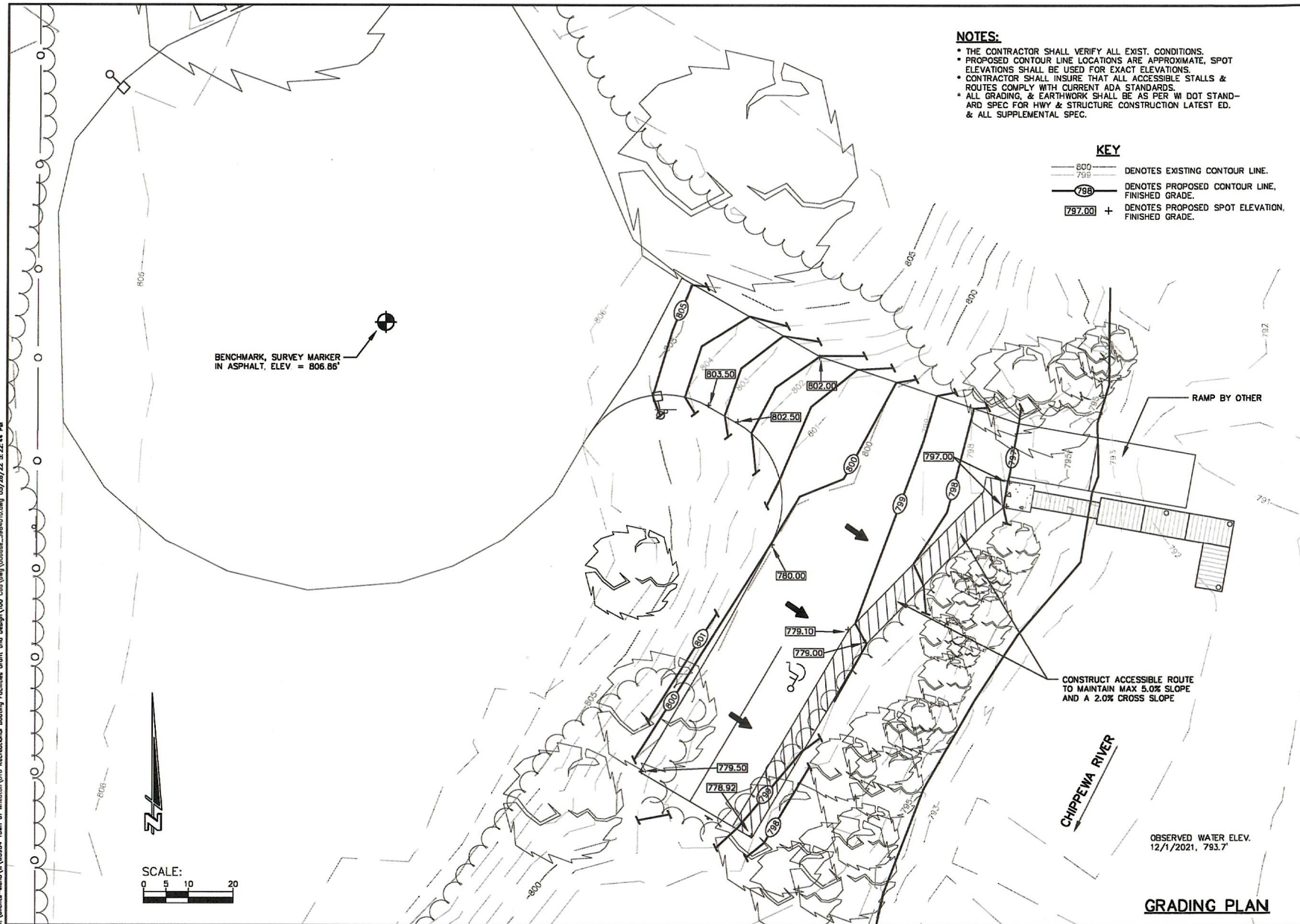

JOB NO. 3984-010
BOOK NO.
DRAWN BY D B
CHECKED BY XX
DATE JAN. 2022
REVISIONS
REFERENCE FILE
DRAWING FILE 00base_3984010.dwg

www.cedarcorp.com
800-472-7372

Cedar Corporation

Engineers, Architects, Planners, Environmental Scientists
Civil Engineers • Landscape Architects • Surveyors • Geologists

1825 Midway Street
Wheaton, IL 60187
TEL: 815-398-3000
FAX: 815-398-3001

624 Midway Ave.
Wheaton, IL 60187
TEL: 815-398-3000
FAX: 815-398-3001

NEW PUBLIC DOCK
TOWN OF WHEATON BOAT LAUNCH
106th STREET
TOWN OF WHEATON, WI

SHEET NO.
C14

I:\Clients-Memo\W\3984 - Town of Wheaton\010 Recreational Boating Facilities Grant and Design\100 Civil\Map\00base_3984010.dwg 05/26/22 2:22:08 PM

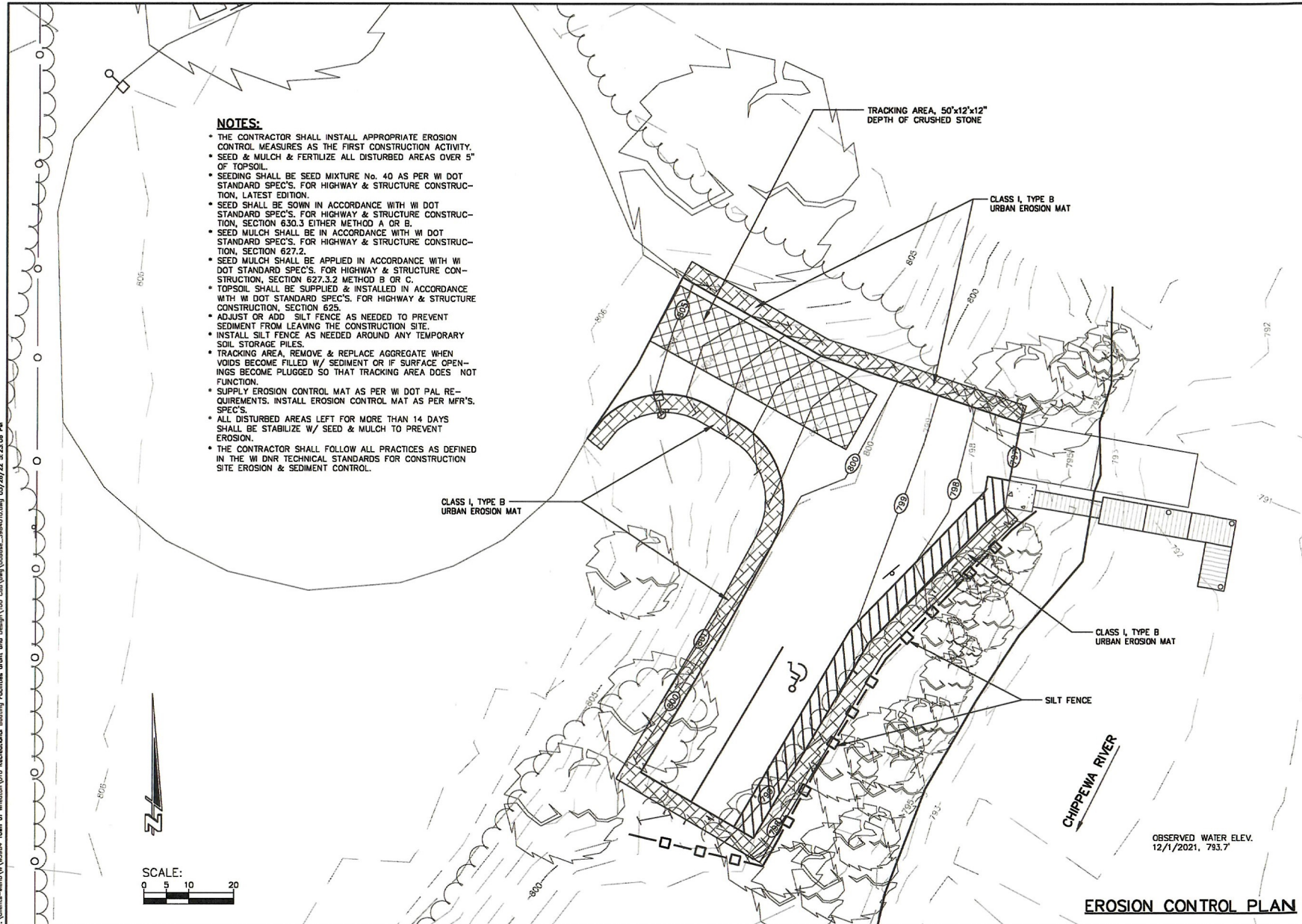

ISS NO.	3984-010
BOOK NO.	
DRAWN BY	D B
CHECKED BY	XX
DATE	JAN. 2022
REVISIONS	
REFERENCE FILE	
DRAWING FILE	00base_3984010.dwg

www.cedarcorp.com
800-472-7372

Cedar Corporation
Erosion Control & Sedimentation Control Systems
1535 Belmont Street
Wheaton, WI 53091
Phone: 262-267-3431
Fax: 262-267-3434

**NEW PUBLIC DOCK
TOWN OF WHEATON BOAT LAUNCH
106th STREET
TOWN OF WHEATON, WI**

SHEET NO.
C15

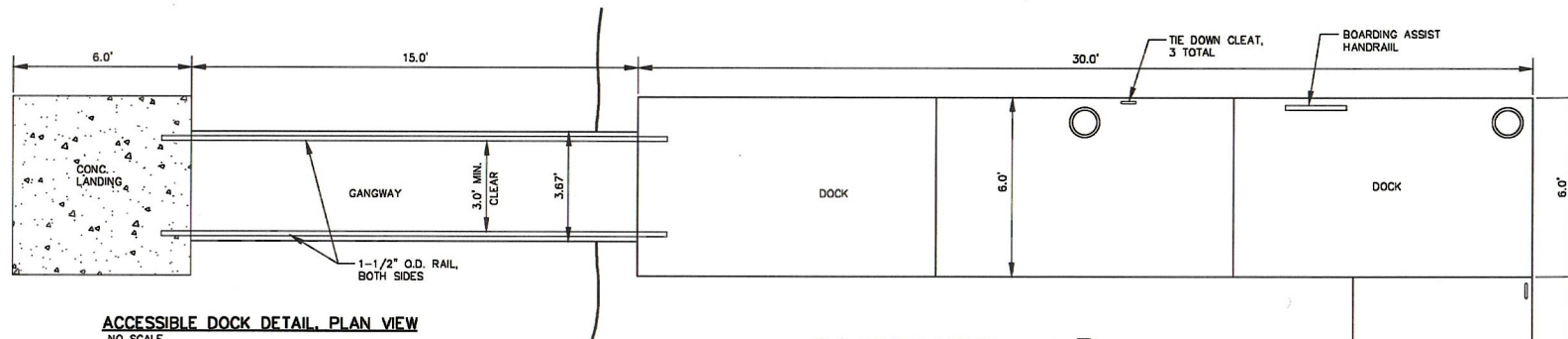

ACCESSIBLE DOCK DETAIL, PLAN VIEW
NO SCALE

NOTES:

- ALL METAL USED ON DOCK & GANGWAY SHALL BE ALUMINUM OR STAINLESS STEEL.
- ALL TRAFFIC SURFACES OF DOCK SHALL BE OF AN NON-SLIP WET & DRY.
- ALL TRAFFIC SURFACES OF GANGWAY SHALL BE OF AN ALUMINUM NON-SLIP TYPE, WET & DRY.
- DOCK BUMPERS SHALL BE PROVIDED FOR ALL DOCK SECTIONS, BOTH SIDES, GRAY IN COLOR.
- GANGWAYS SHALL HAVE ADEQUATE FLOTATION TO BE BUOYANT DURING HIGH WATER.
- THE FLOATING STRUCTURES SHALL BE DESIGNED TO RESIST A 400 POUND POINT LOAD AT ANY POINT ON THE MAIN DOCK WITHOUT VIOLATION OF THE FREEBOARD OR TORSION DESIGN REQUIREMENT.
- THE SYSTEM SHALL BE DESIGNED TO RESIST TORSIONAL FORCES TO THE EXTENT THAT THERE SHALL BE NO MORE THAN 3" FREEBOARD VARIATION PER 100' OF ANY LENGTH AS MEASURED IN ANY DIRECTION & UNDER ANY COMBINATION OF SPECIFIED VERTICAL & HORIZONTAL LOAD CONDITIONS EXCEPT WAVE ACTION LOADS.
- ADDITIONAL FLOTATION SHALL BE ADDED TO THE FLOATING DOCK WHERE NEEDED TO SUPPORT THE COMBINED DOCK AND GANGWAY LOADS WITHOUT PRODUCING UNDUE DISTORTION IN THE FLOATING STRUCTURE.
- DOCK SURFACE AND STRUCTURAL FRAME LIVE LOAD SHALL BE EQUAL TO 50 P.S.F. APPLIED TO THE FULL SURFACE AREA OF THE DOCK.
- CONTRACTOR SHALL SUBMIT FLOATING DOCK SYSTEM SHOP DRAWINGS TO ENGINEER FOR APPROVAL BEFORE MANUFACTURING. SHOP DRAWINGS SHALL BE SIGNED & STAMPED BY A WI REGISTERED ENGINEER.
- DRIVE 10" dia. PILES TO 15 TONS, 20' MIN. EMBEDMENT.
- FILL 10" dia. PILES W/ CONCRETE, FINISH & CHAMFER TOPS.
- PAINT 10" dia. STEEL PILES TO CONFORM TO THE REQUIREMENTS OF THE EPOXY SYSTEM OR THE VINYL SYSTEM, AS PER WI DOT STANDARD SPECS. FOR HWY. & STRUCTURE CONST., CONTRACTOR SHALL SUBMIT PROP. PAINTING SYSTEM TO ENGINEER FOR APPROVAL.
- FLOATING DOCKS SHALL BE CONSTRUCTED IN SECTIONS SO THAT DOCKS CAN BE REMOVED FOR MAINTENANCE.

TOP OF STEEL PILES, 816.00, FILL
PILES W/ CONC., CHAMFER TOPS, TYP.

10" DIA. STEEL PILE, TYP.

TOP OF STEEL PILES, 816.00, FILL
PILES W/ CONC., CHAMFER TOPS, TYP.

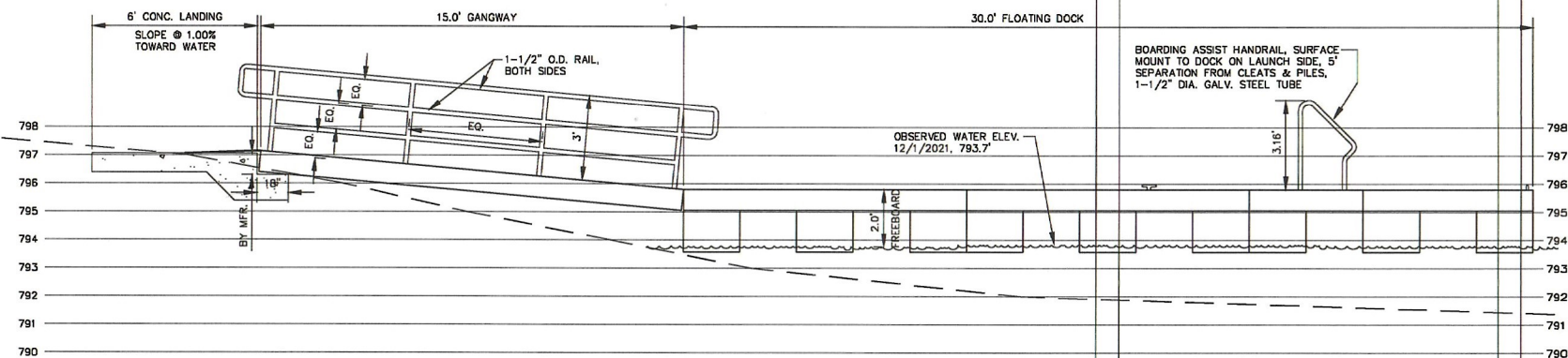

ACCESSIBLE DOCK DETAIL, ELEVATION
NO SCALE

DETAILS

SHEET NO.	3984-010
BOOK NO.	
DRAWN BY	D B
CHECKED BY	XX
DATE	JAN. 2022
REVISIONS	
REFERENCE FILE	
DRAWING FILE	00base_3984010.dwg

www.cedarcorp.com
800-472-7372

Cedar Corporation
engineers • architects • planners • environmental scientists
and designers • landscape architects • interior designers

1825 Belmont Street
Belmont, MA 02458
TEL: 617-352-2000 FAX: 617-352-2001

1000 West 10th Avenue
Wheaton, IL 60187
TEL: 630-261-8000 FAX: 630-261-8001

NEW PUBLIC DOCK
TOWN OF WHEATON BOAT LAUNCH
106th STREET
TOWN OF WHEATON, WI

SHEET NO.

C10

I:\Clients-Memo\VA\3984 Town of Wheaton\010 Recreation\Boat Launch\Drawings\010_Cad\Drawings\010base_3984010.dwg 10/26/22 5:24:22 PM

I:\Clients\Menu\W3884 Team of Wheaton\1010 Recreation\Boiling Facilities\Draw and Design\100 Civil\Draw\00base_3984010.dwg 05/26/22 5:33:39 PM

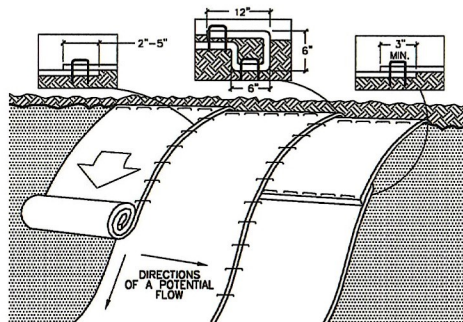

- * PREPARE SOIL BEFORE INSTALLING ROLLED EROSION CONTROL MAT, INCLUDING GRADING, TOPSOIL, SEED & FERTILIZER.
- * BEGIN AT TOP OF SLOPE, BY ANCHORING MAT IN TRENCH. INSTALL STAPLES 12" APART, SEE DETAIL.
- * ROLL MAT DOWN SLOPE AS SHOWN. FASTEN MAT TO SOIL SURFACE W/ STAPLES. STAPLE PATTERN GUIDE BY MFR.
- * OVERLAP MAT AS PER MFRS. SPEC.
- * NORTH AMERICAN GREEN, USA 1-800-772-2040, www.nogreen.com.

EROSION CONTROL MAT DETAIL NO SCALE

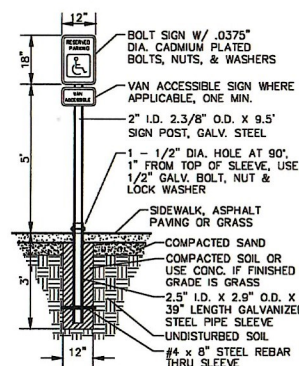

ACCESSIBLE PARKING SIGN NO SCALE

NOTE: SIGN SHALL COMPLY W/ CURRENT STATE & ADA GUIDELINES.

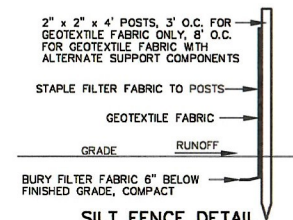

SILT FENCE DETAIL

- NOTES: NO SCALE
- * SILT FENCE SHALL BE SUPPLIED & INSTALLED AS PER THE WI DOT STANDARD SPECIFICATIONS FOR HIGHWAY & STRUCTURE CONSTRUCTION.

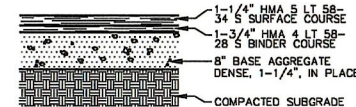

ASPHALT TYPICAL SECTION NO SCALE

NOTE: ASPHALT, BASE COURSE & COMPACTION SHALL BE SUPPLIED & INSTALLED AS PER WI DOT STANDARD SPEC. FOR HWY & STRUCTURE CONSTRUCTION, LATEST ED.



TRACKING AREA NO SCALE

NOTES: * SUPPLY CRUSHED STONE AS PER WI DNR STANDARD, 1057, TRACKOUT CONTROL PRACTICES.

* REMOVE & REPLACE STONE WHEN VOIDS BECOME FILLED W/ SEDIMENT OR IF SURFACE OPENINGS BECOME PLUGGED SO THAT TRACKING AREA DOES NOT FUNCTION.

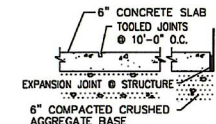

6" CONCRETE NO SCALE

NOTE: * 6" CONC. SHALL HAVE 10"x10"-W2.9x W2.9 OR 6"x6"-W2.9xW2.9 WIRE MESH MAINTAIN 3" COVER OVER MESH.

DETAILS

JOB NO.	3984-010
BOOK NO.	
DRAWN BY	D B
CHECKED BY	XX
DATE	JAN. 2022
REVISIONS	
REFERENCE FILE	
DRAWING FILE	00base_3984010.dwg

www.cedarcorp.com
800-472-7372

Cedar Corporation

1500 Belmont Street
Wilmington, NC 28403
919-399-2000
FAX 919-399-2001

1500 Belmont Street
Wilmington, NC 28403
919-399-2000
FAX 919-399-2001

NEW PUBLIC DOCK
TOWN OF WHEATON BOAT LAUNCH
106th STREET
TOWN OF WHEATON, WI

SHEET 1A

C17